

SGC



SGC BLOCK

LIFT KIT

FITS CLUB CAR PRECEDENT

BLOCK LIFT KIT INSTALLATION INSTRUCTIONS

CLUB CAR PRECEDENT

After installing this lift kit, the front wheels must be properly aligned. Failure to properly align the front wheels may result in decreased ability to control the golf cart which may result in a rollover or crash.

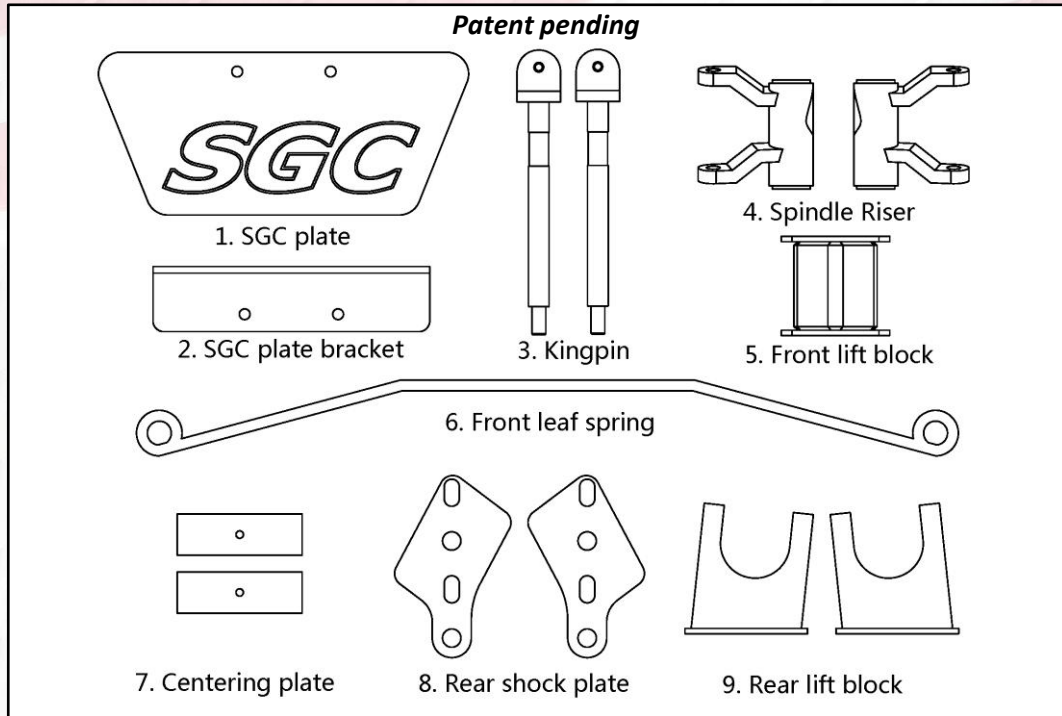

USED PLACE	SEQUENCE	NAME	SPEC.	QTY.
FRONT LEAF SPRING	10	HEX BOLT	3/8-16*2	4
		FLAT WASHER	3/8	4
SPINDLE RISER	11	HEX BOLT	1/2-13*1 3/4	2
		FLAT WASHER	1/2	2
		NUT	1/2-13	2
KINGPIN TO LEAF SPRING	12	HEX BOLT	3/8-16*3 1/2	2
		NUT	3/8	2
		FLAT WASHER	3/8	4
KINGPING TO A-ARM	13	NUT	M12	2
SGC PLATE	14	HEX BOLT	3/8-16*1	2
		NUT	3/8	2
		FLAT WASHER	3/8	2
REAR SUSPENSION REAR LIFT BLOCK	15	HEX BOLT	M12-180	4
		LOCK NUT	M12	4
		FLAT WASHER	M12	8
REAR SUSPENSION CENTERING PLATE	16	HEX BOLT	1/4-1/2	2
		FLAT WASHER	1/4	4
		LOCK NUT	1/4	2

BLOCK LIFT KIT INSTALLATION INSTRUCTIONS

CLUB CAR PRECEDENT

To begin, be sure to engage the parking brake and switch your cart to "off". Also make sure RUN/TOW switch is in TOW position.

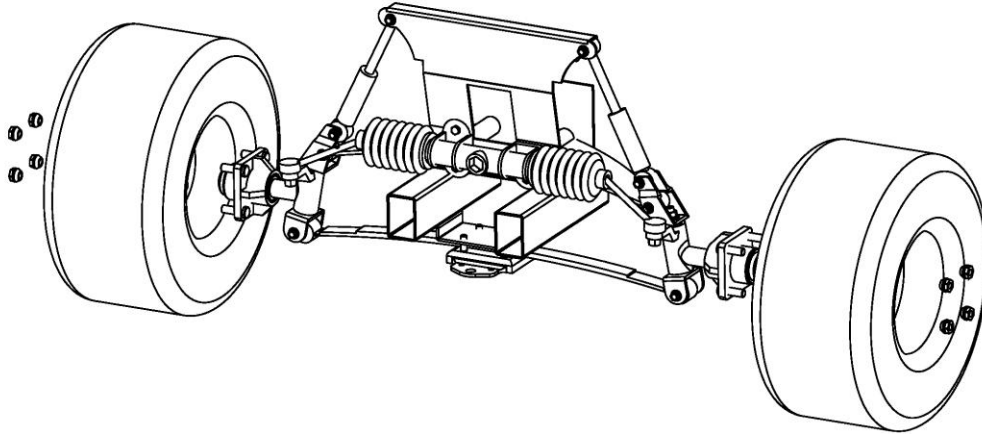

1. Remove lug nuts when cart on ground. Then raise the cart with jack stands under the frame. Remove wheel from the hub. Detach front bumper and retain hardware.

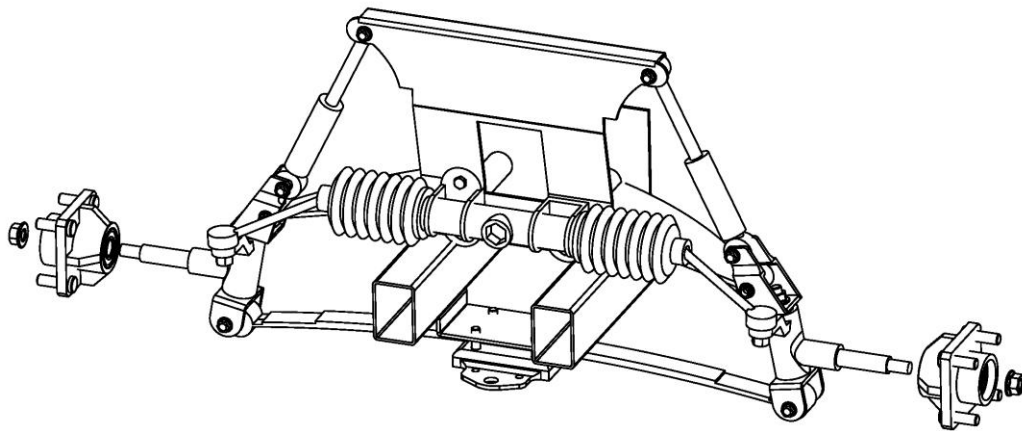

2. Using a 21mm socket remove and retain hub and flange nut. Repeat on passenger side.

BLOCK LIFT KIT INSTALLATION INSTRUCTIONS

CLUB CAR PRECEDENT

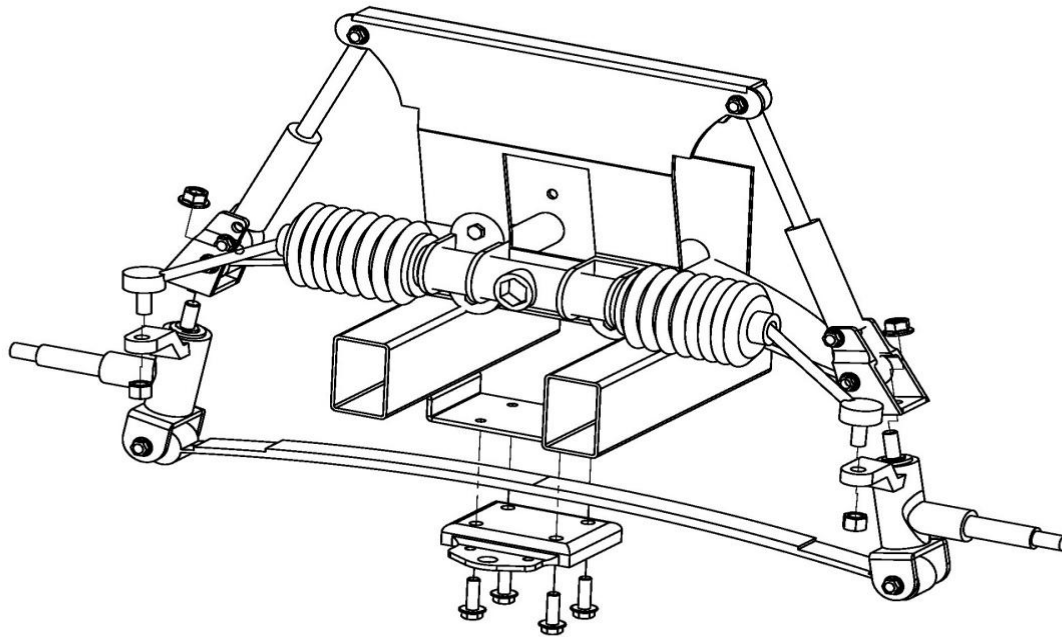

3. Remove front leaf spring, remove front leaf spring retaining plate, remove spindles.

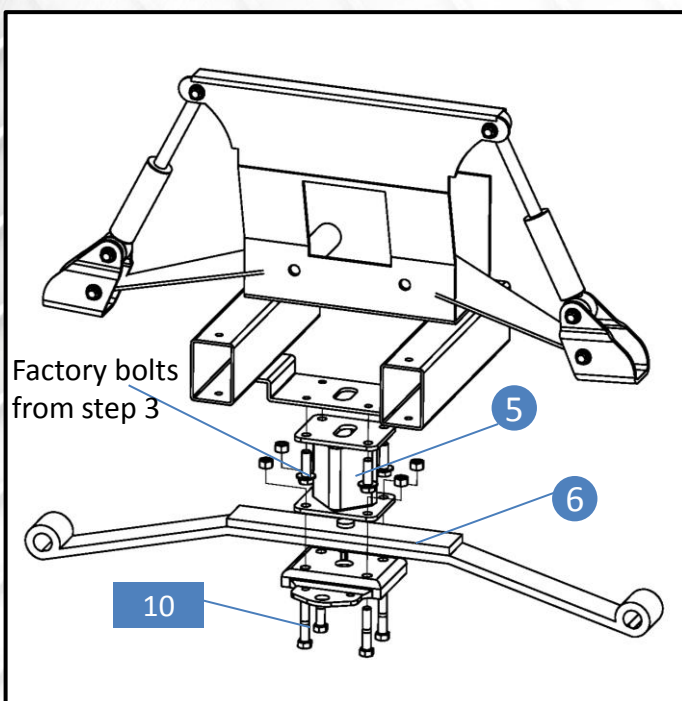

4. Attach retaining plate to front lift block #5 with supplied leaf spring #6 sandwiched in middle, using supplied hardware #10 to secure. Attach lift block assembly to cart frame using hardware from step 3.

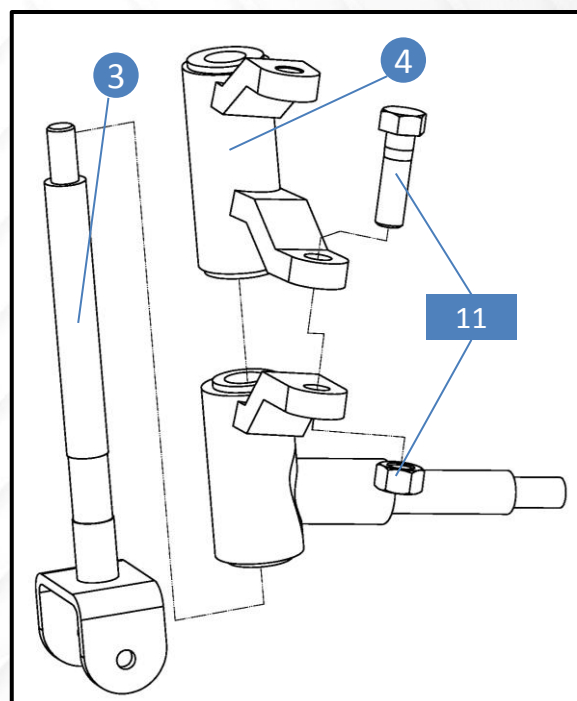

5. Before moving to next step, install spindle riser #4 and factory spindle on supplied kingpin #3 with supplied hardware #11.

BLOCK LIFT KIT INSTALLATION INSTRUCTIONS CLUB CAR PRECEDENT

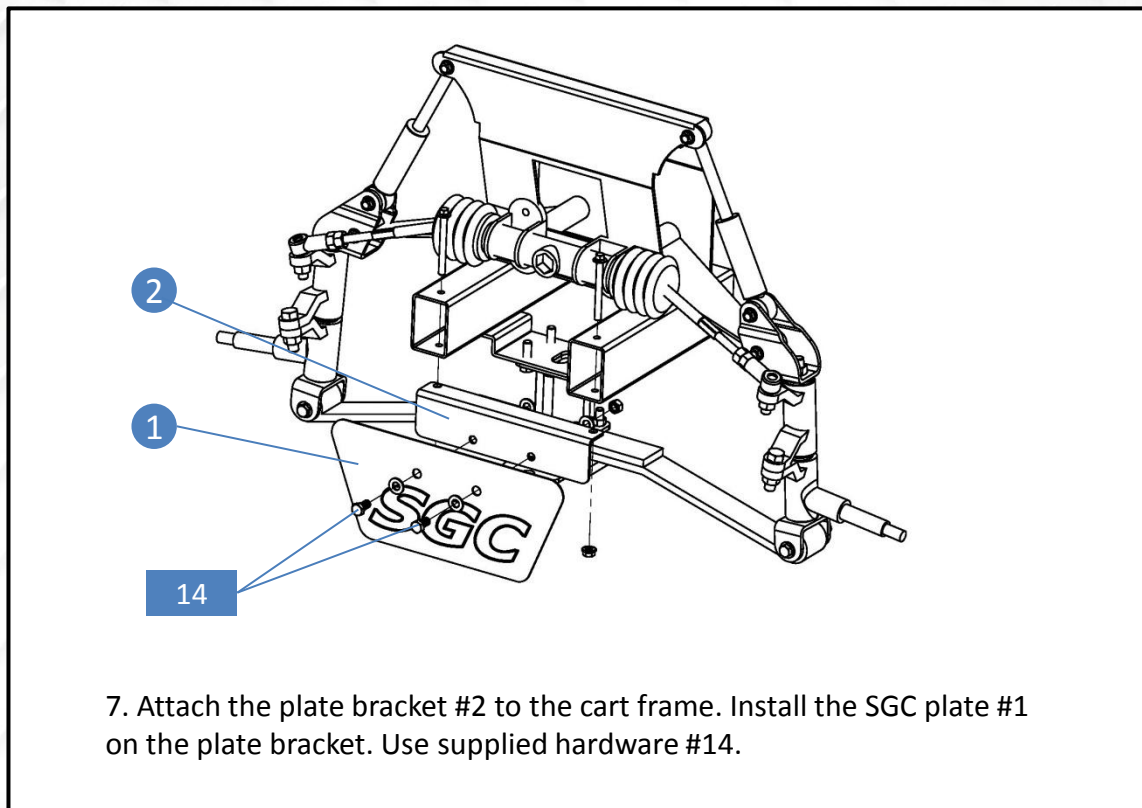
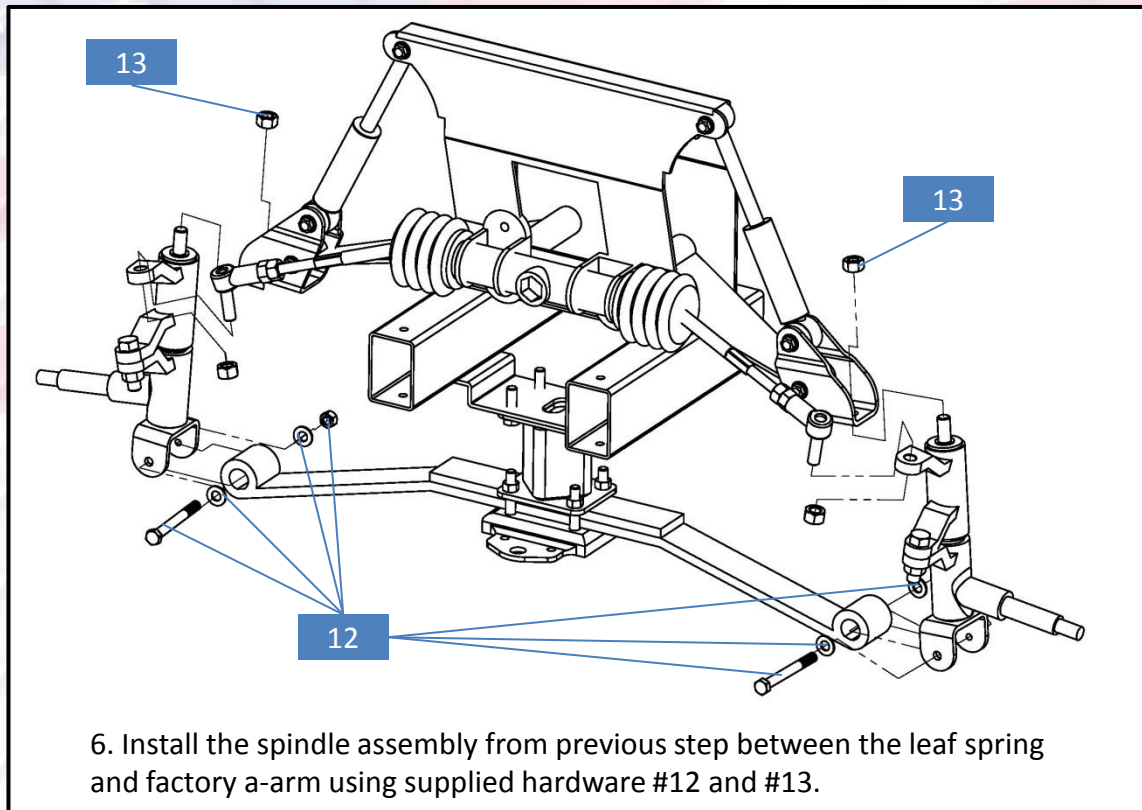

BLOCK LIFT KIT INSTALLATION INSTRUCTIONS
CLUB CAR PRECEDENT

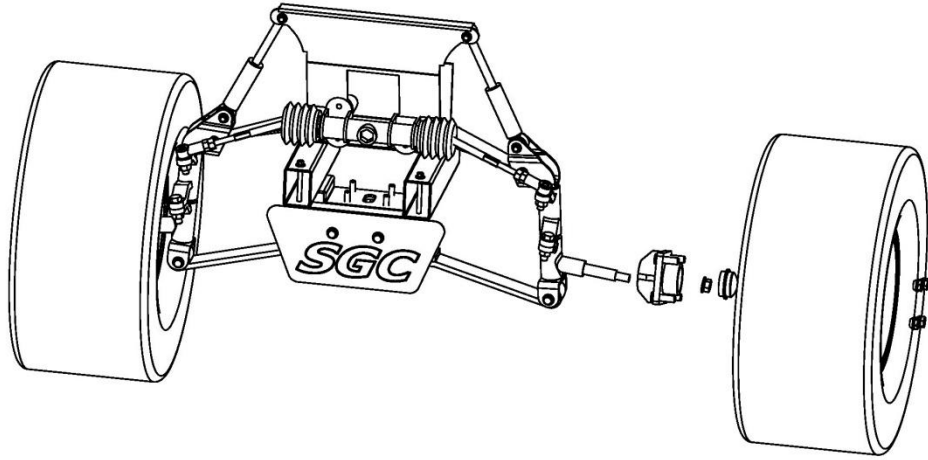

8. Reinstall hub and larger wheels.

BLOCK LIFT KIT INSTALLATION INSTRUCTIONS CLUB CAR PRECEDENT

Chock front wheels, then disengage parking brake. Lift rear of Cart and support with jack stands under the frame. Remove rear wheels. Leave jack in place under axle and motor assembly.

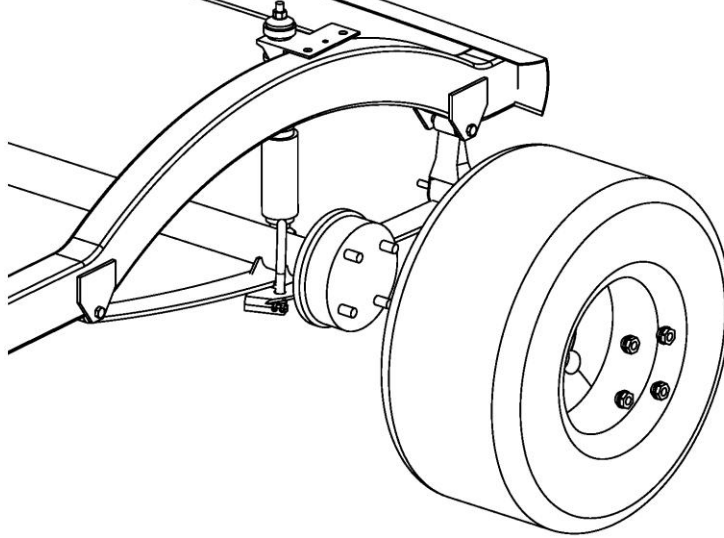

9. Remove rear wheels.

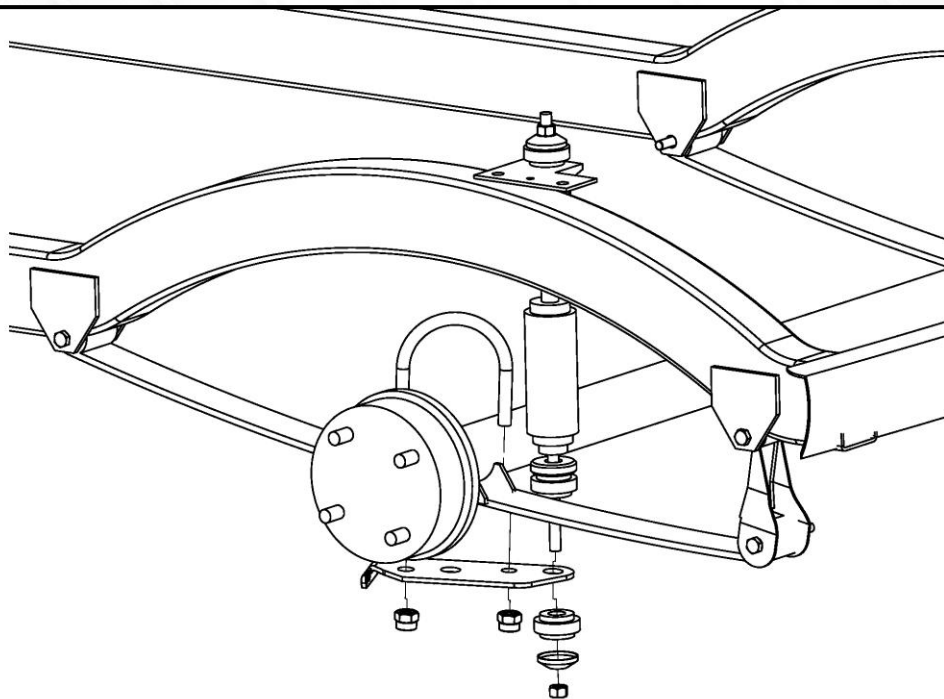

10. Using a 5/8" socket loosen the U-bolts on the passenger side. Don't remove the U-bolts. It's important to do one side at a time to avoid motor roll. Loosening but not removing the U-bolts will make this easier.

BLOCK LIFT KIT INSTALLATION INSTRUCTIONS CLUB CAR PRECEDENT

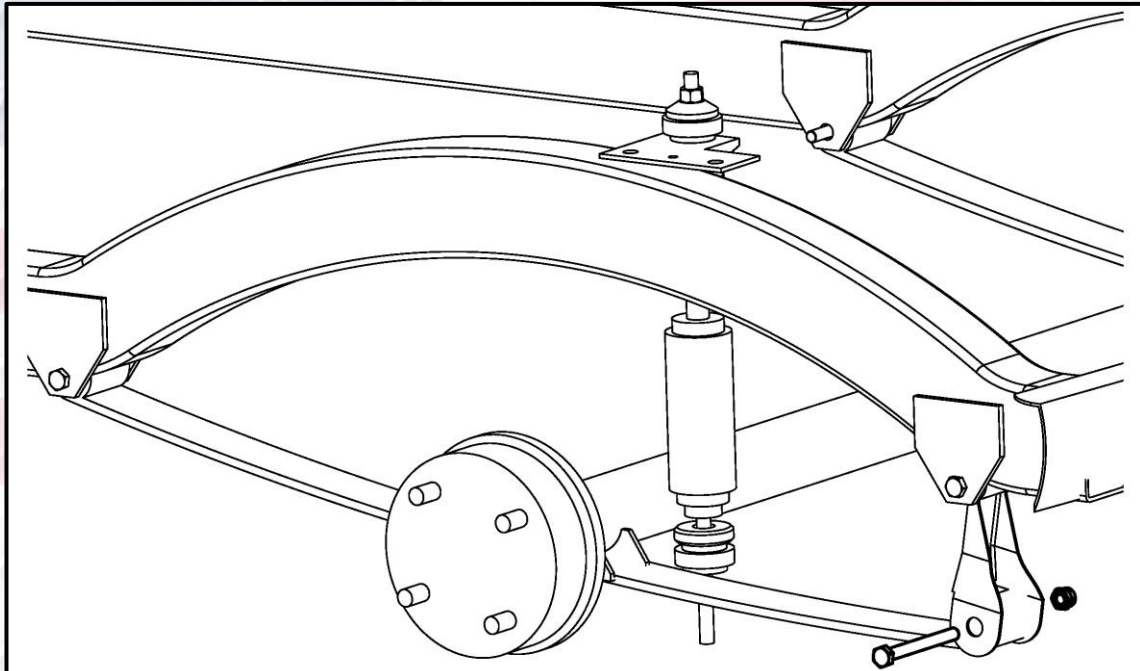

11. Using a 10mm socket and 13mm wrench remove hardware from rear leaf spring mount and front leaf spring mount. Retain hardware.

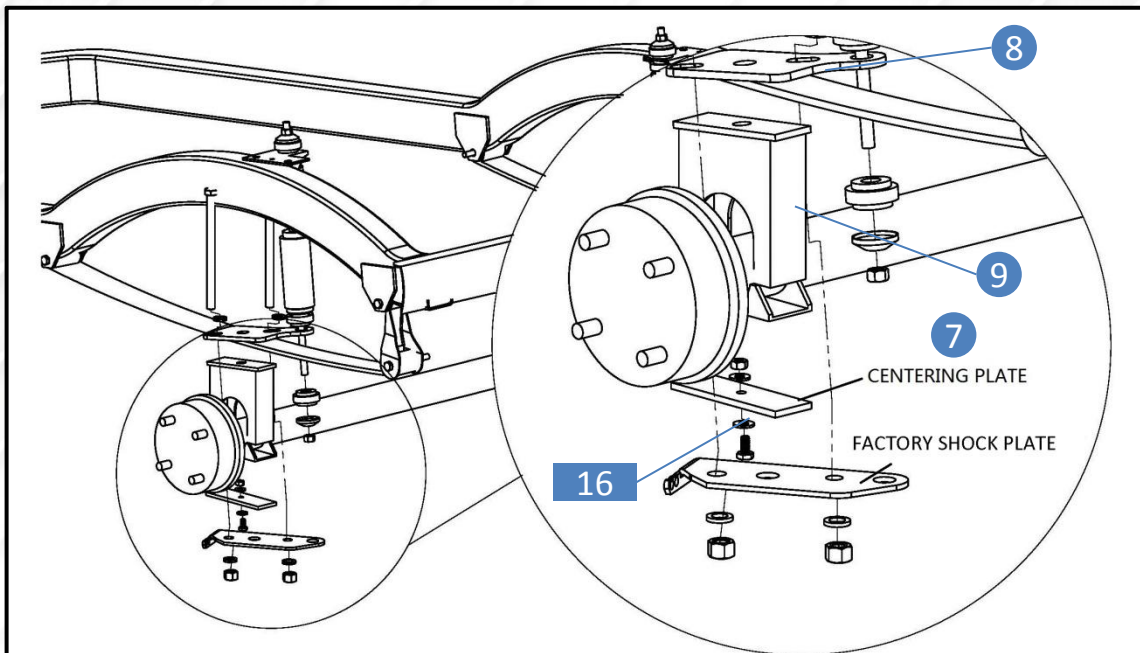

13. Place rear lift block #9 on the axle and under leaf spring. Ensure that top of lift block angles down toward the front of cart. Place rear shock plate #8 over leaf spring and attach shock to it. Attach hardware #16 on centering plate #7 then attach centering plate to factory shock plate. The bolt head and nut will fit into the center hole of the spring perch and factory shock plate to aid in alignment of the riser and mounting plates.

BLOCK LIFT KIT INSTALLATION INSTRUCTIONS CLUB CAR PRECEDENT

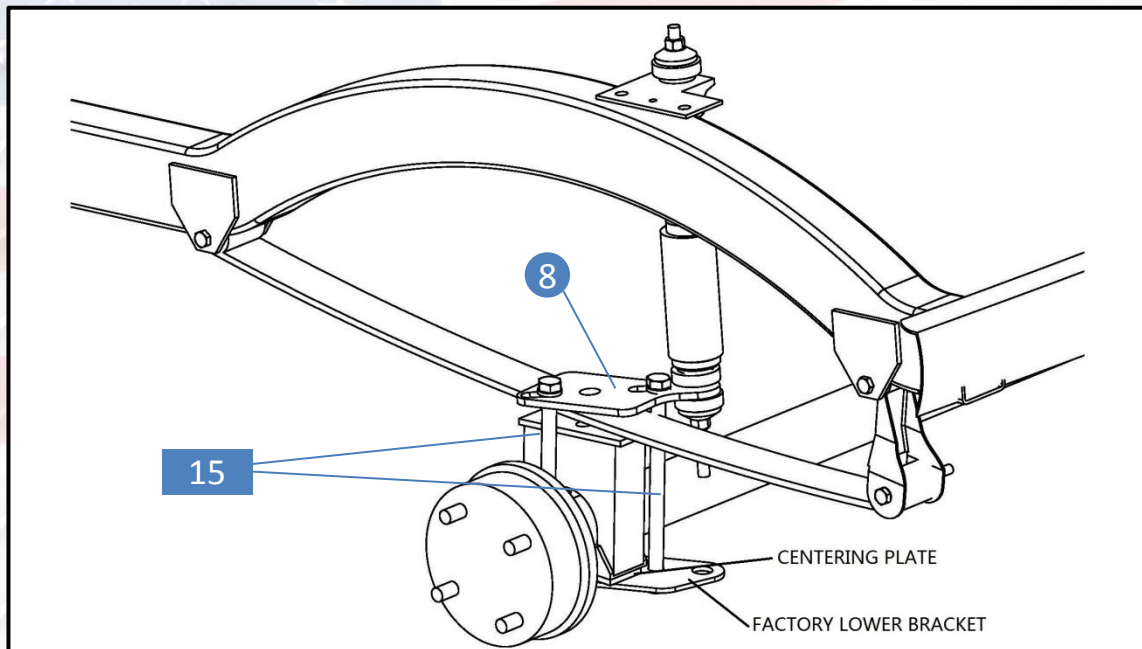

13. Route supplied bolts M12*180 through shock mounting plate, rear lift block and factory shock plate. Using socket to tighten these four bolts evenly to ensure proper alignment.

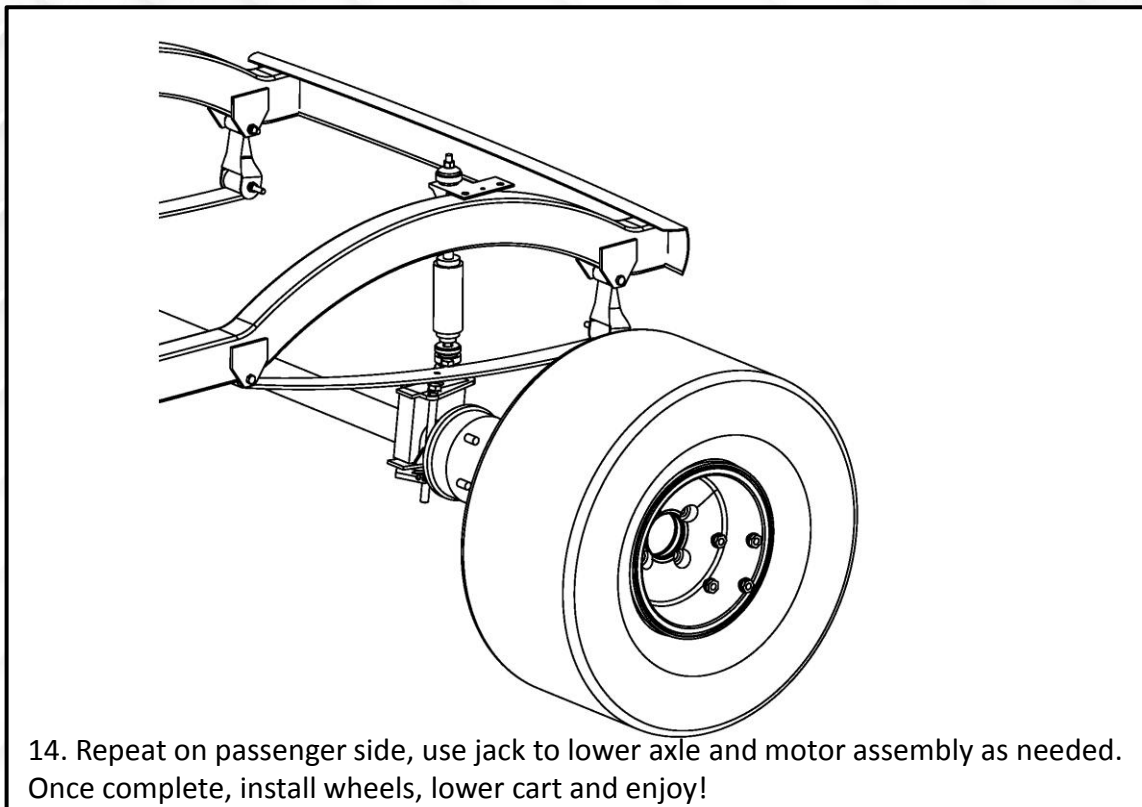

14. Repeat on passenger side, use jack to lower axle and motor assembly as needed. Once complete, install wheels, lower cart and enjoy!



RETURN MERCHANDISE AUTHORIZATION

Dear Valued Customer,

Thank you for choosing Steeleng Golf Cart Accessories for your golf cart needs.

We apologize for the issues you are having with your purchase. We strive to offer the absolute best quality at the absolute best price.

To best serve you, we do need a little information to help process your return and/or exchange faster.

Please complete the following and include this entire form with your return.

Name

Shipped To Address

STATE

ZIP

Purchased with: eBay Direct Phone Order

This is for EXCHANGE REFUND

Please describe reason for return:-

Our Return Address:
Steeleng Golf Cart Accessories
3309 Laurens Road,
Greenville, SC 29607
Tele: 864-675-1103

For Office Use Only:

Received By: _____

Date _____

Refund Amount _____

Exchange Issued _____

**Steeleng Golf Cart Accessories reserves the right to charge a 15% restocking fee for all returned and/or exchanged items.