

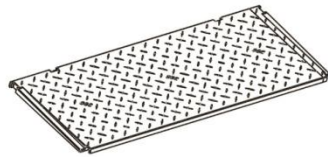

GOLF CART REAR FLIP SEAT KIT

FITS EZGO TXT

**SEAT KIT INSTALLATION INSTRUCTIONS**  
**EZGO TXT**



**SEAT BOTTOM**



**TAB**

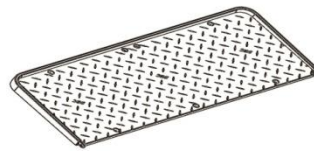

**FLIP SEAT**



**SEAT CUSHION**

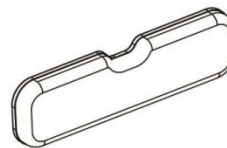

**BACK CUSHION**

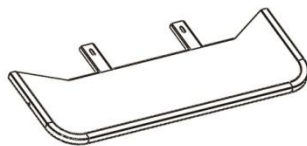

**FOOT PLATE**

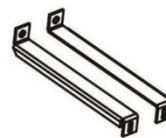

**VERTICAL SUPPORTS**

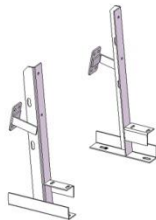

**SEATBACK BRACKET**

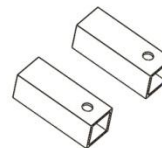

**SPACER** (WORKS ON 14+TXT ONLY)

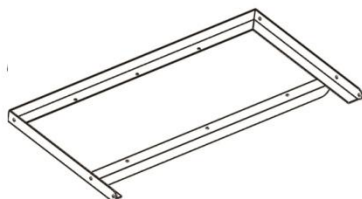

**SEAT BOTTOM FRAME**

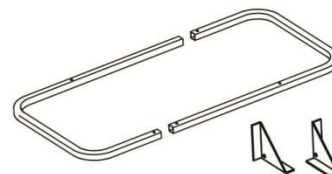

**ARM TUBE & TRIANGLE BRACKET**

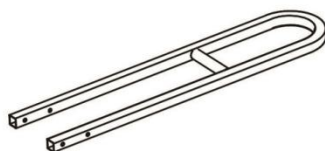

**GRAB BAR**

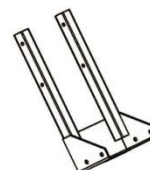

**GRAB BAR MOUNTING BRACKET**

## SEAT KIT INSTALLATION INSTRUCTIONS

### EZGO TXT

Bag#	Spec.		Qty.
1	Hex bolt	3/8-16*1-1/2	4
	Flat washer	3/8	8
	Spring washer	3/8	4
	Hex nut	3/8	4
2	Hex bolt	3/8-16*2	2
	Flat washer	3/8	4
	Spring washer	3/8	2
	Hex nut	3/8-16	2
3	Hex bolt	1/4-1	4
	Flat washer	1/4	8
	Lock Nut	1/4	4
4	Clamps		2
	Philip screw	M6*14	2
5	Philip screw	M6*14	4
	Flat washer	M6*30	2
6	Philip screw	M6*14	2
	Plastic cap	16mm	2
	Lock Nut	M6	2
7	Philip screw	5/16*1-1/8	2
	Nylon Spacer		2
	Flat washer	5/16	4
	Lock Nut	5/16	2
8	Plastic cap	16mm	5
	Self-tapped screw	M6*25	5
9	Hex bolt	5/16-18*1-1/2	4
	Hex bolt	5/16-18*2-1/2	2
	Flat washer	5/16	12
	Lock Nut	5/16-18	6
10	Flat washer	1/4	4
	Hex bolt	1/4-20*1	4
11	Hex bolt	1/4-20*1-3/4	8
	Flat washer	1/4	16
	Lock Nut	1/4-20	8
12	Hex bolt	5/16-1 3/4	4
	Flat washer	5/16	8
	Lock nuts	5/16	4



## SEAT KIT INSTALLATION INSTRUCTIONS EZGO TXT

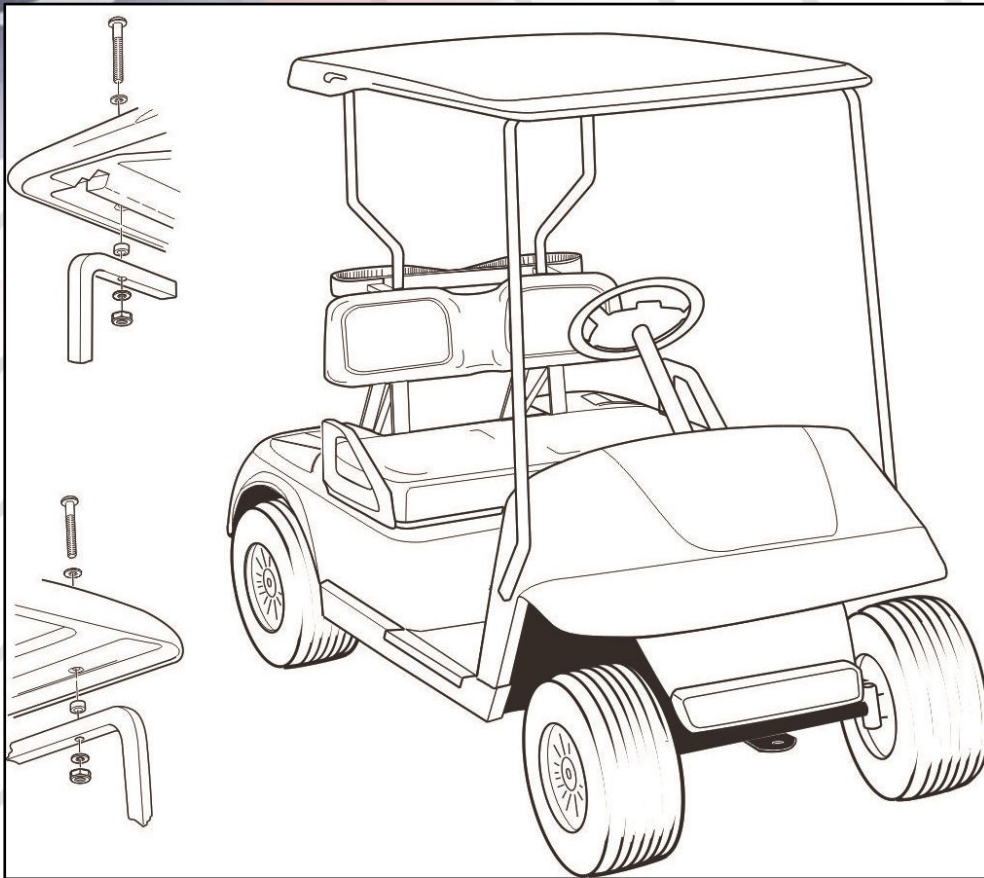

1. Remove factory canopy.

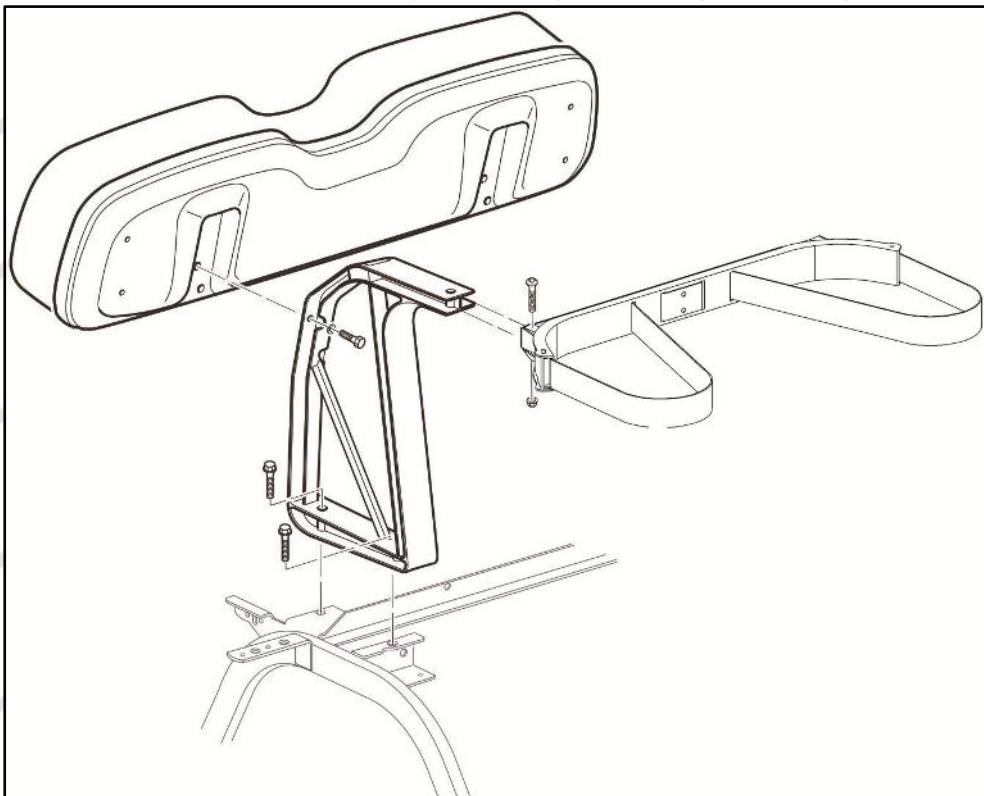

2. Remove front back cushion.

## SEAT KIT INSTALLATION INSTRUCTIONS EZGO TXT

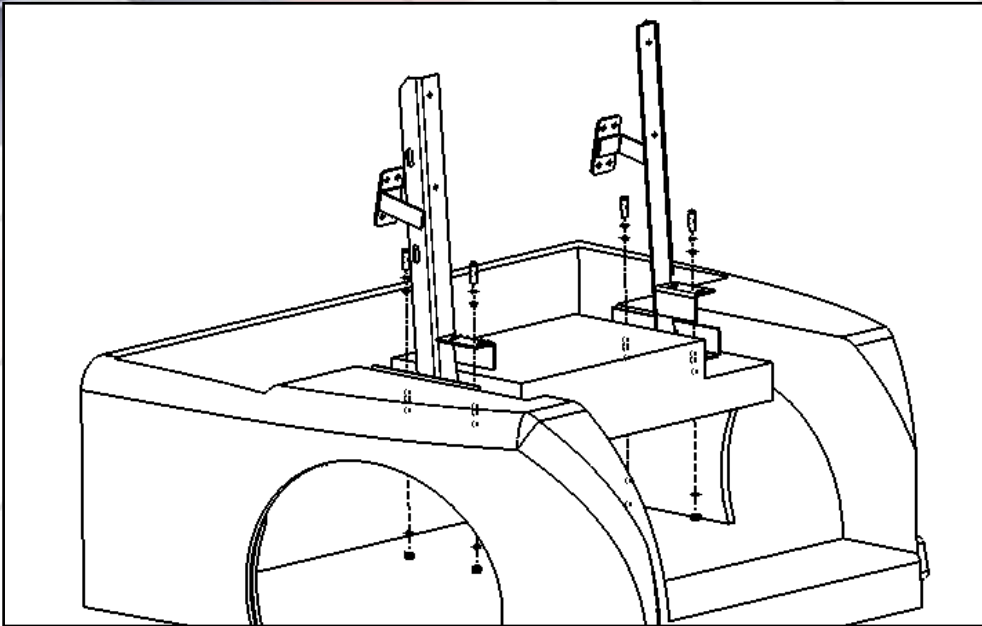

3. Attach seatback bracket to cart using hardware #1. Please note seatback brackets are directional as indicated.

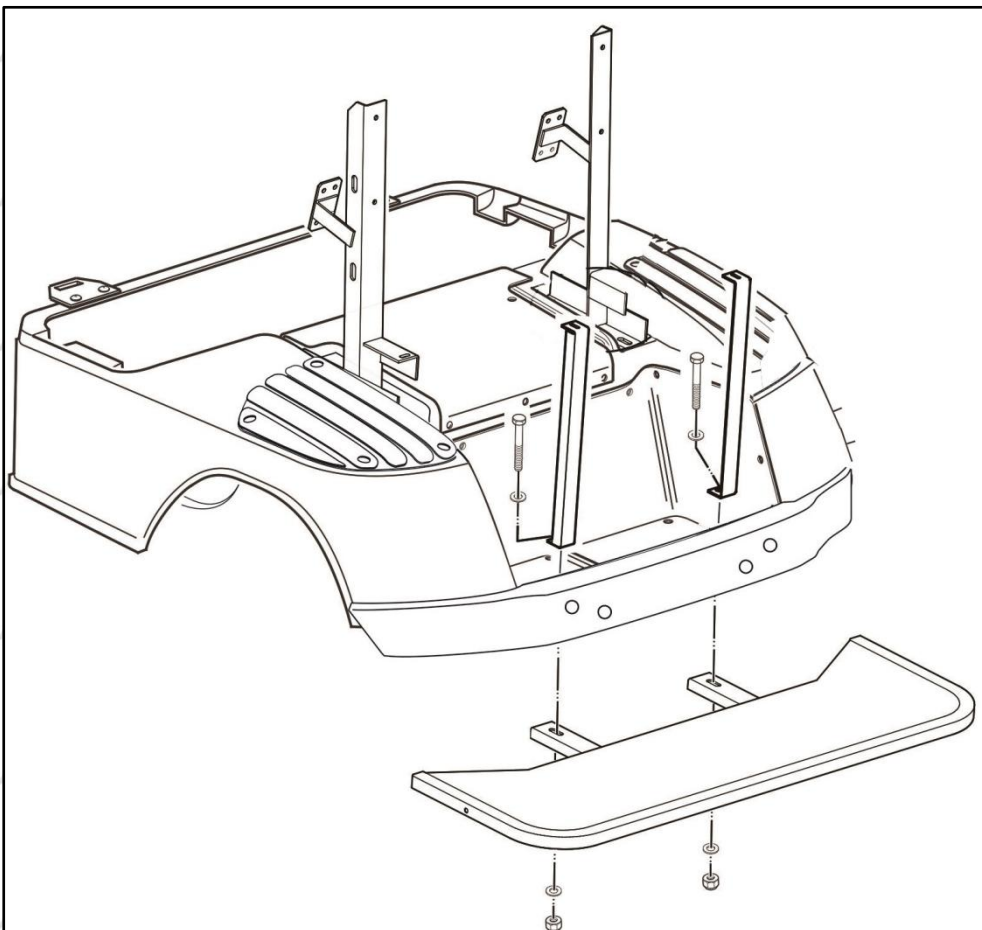

4. Remove factory bag well rivets and drill out holes with a 1/2" drill bit. Line up the holes on vertical supports with the holes drilled, put through bolts from hardware #2. Attach foot plate to protruding bolts and secure with washers and nuts.

## SEAT KIT INSTALLATION INSTRUCTIONS EZGO TXT

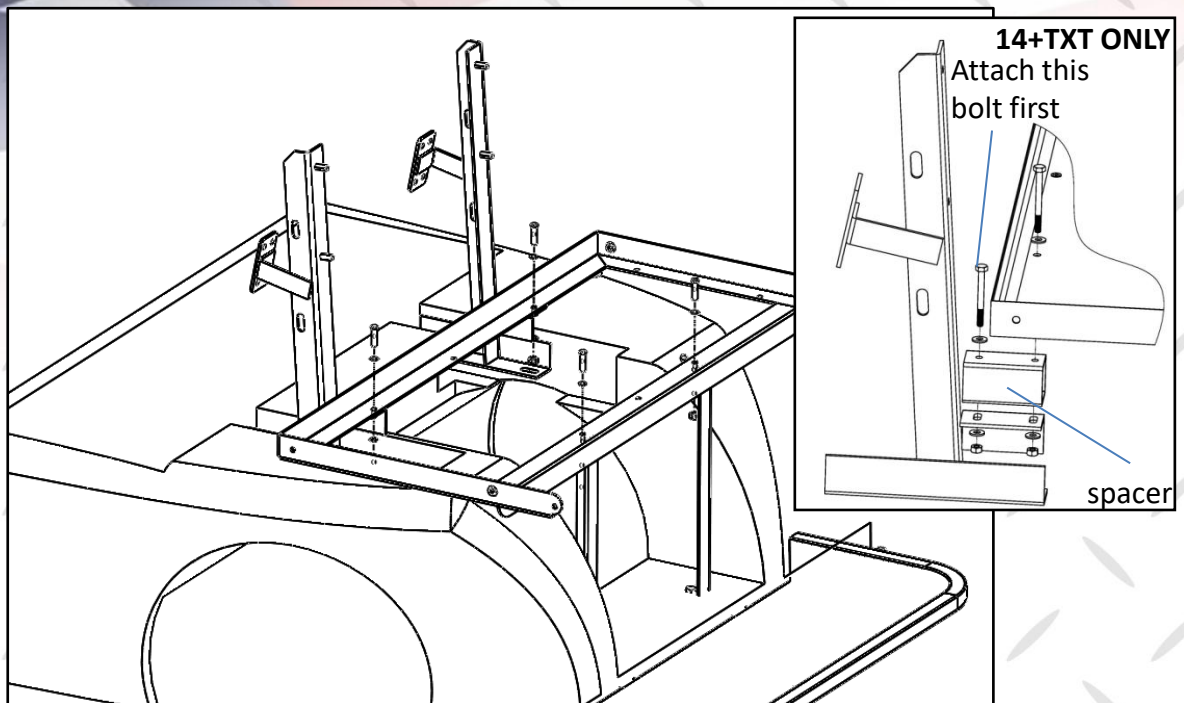

5. Attach seat bottom steel frame to seatback bracket and to vertical supports using hardware #3. **FOR 14+ TXT ONLY** *Attach spacer to seatback bracket using premounted bolts through the inside mounting holes. Then attach seat bottom frame as indicated through outside mounting holes.*

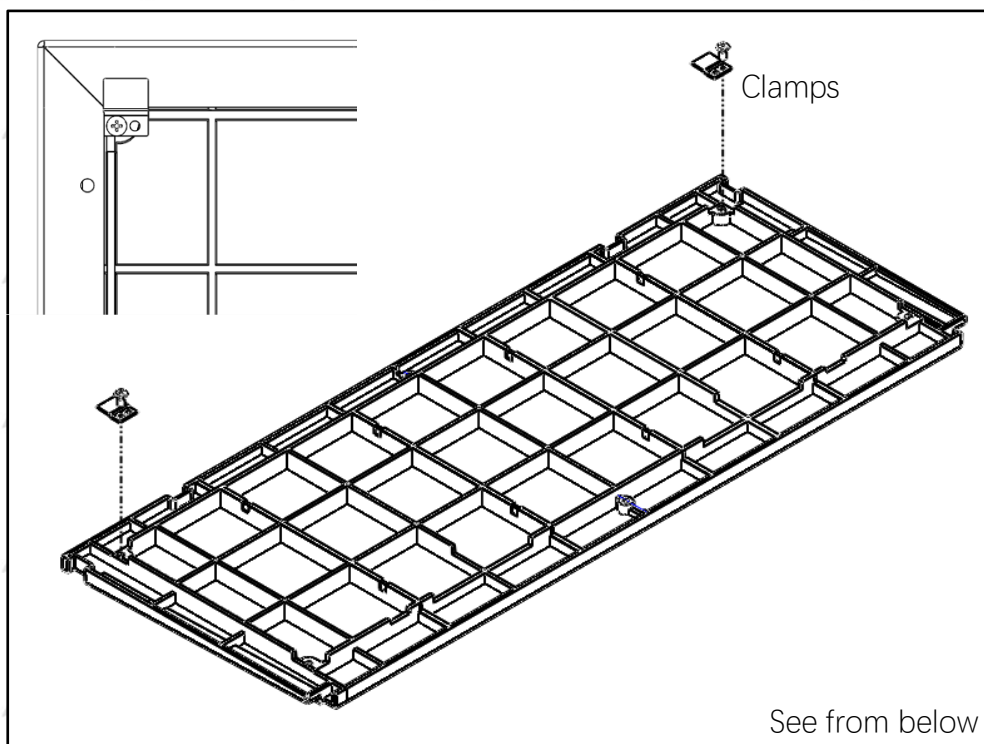

6. Attach clamps to existing mounting holes at corners below seat bottom using hardware #4.



## SEAT KIT INSTALLATION INSTRUCTIONS EZGO TXT

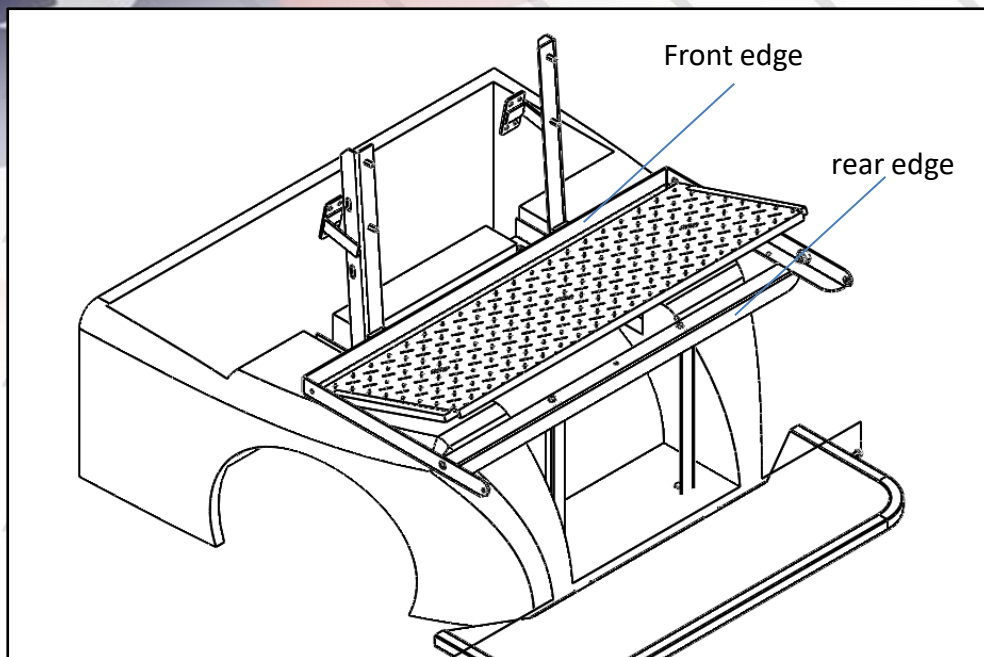

7. Flip over the seat bottom and use clamps to clamp the seat bottom to front edge of the seat bottom steel frame. Front means the front of cart.

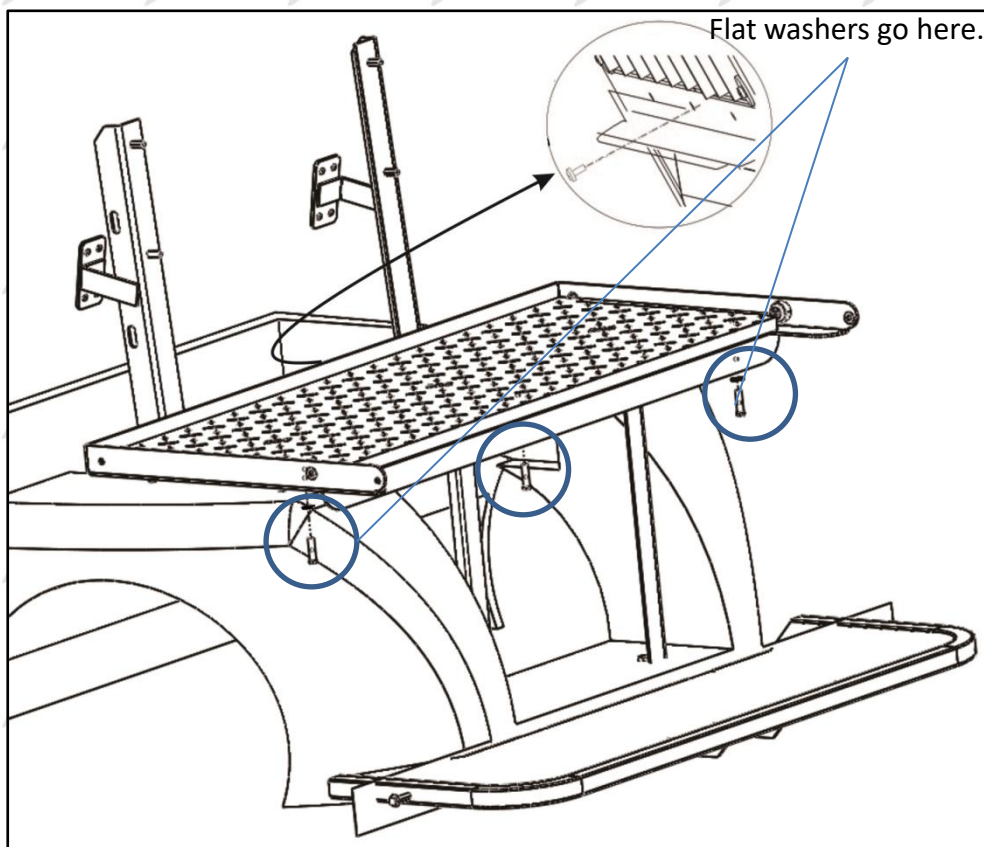

8. Attach rear end of seat bottom to seat bottom frame by existing mounting holes using hardware #5. Two flat washers in the hardware bag are used at two corners as indicated. The last bolt goes to the middle of front edge.

## SEAT KIT INSTALLATION INSTRUCTIONS EZGO TXT

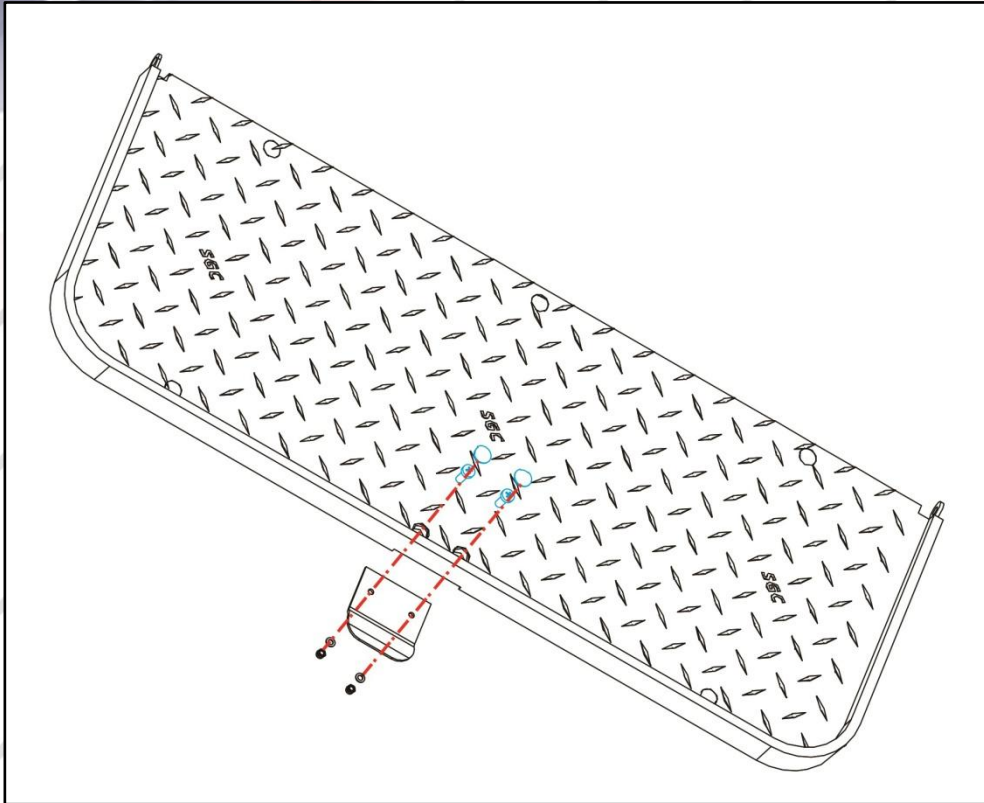

9. Attach tab to flip seat using hardware #6.

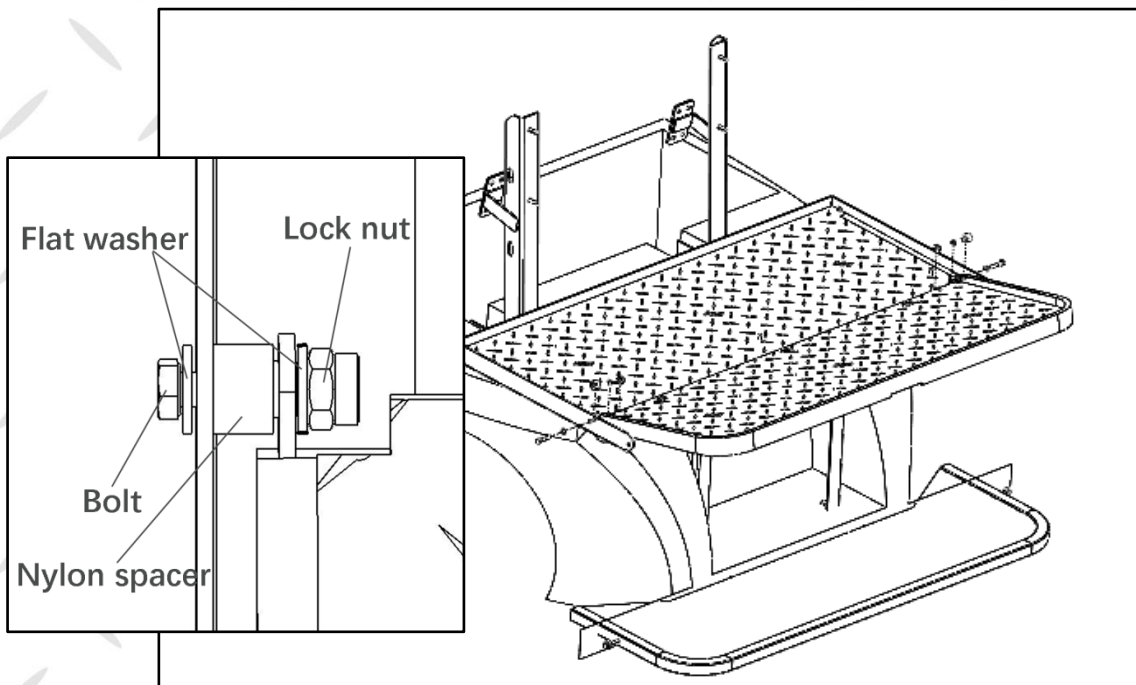

10. Attach flip seat to seat frame/seat bottom assembly using hardware #7. Nylon spacers from hardware #7 is used between two parts. Detailed picture is seen from the top of the connection.



## SEAT KIT INSTALLATION INSTRUCTIONS EZGO TXT

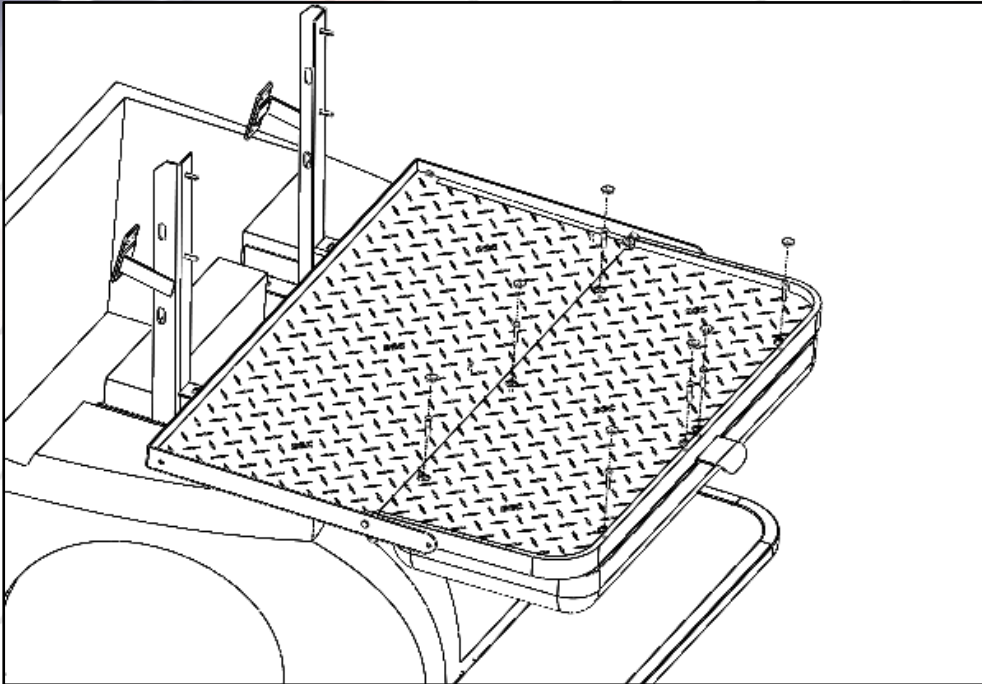

11. Flip over the flip seat part and attach seat cushion to flip seat using hardware #8.

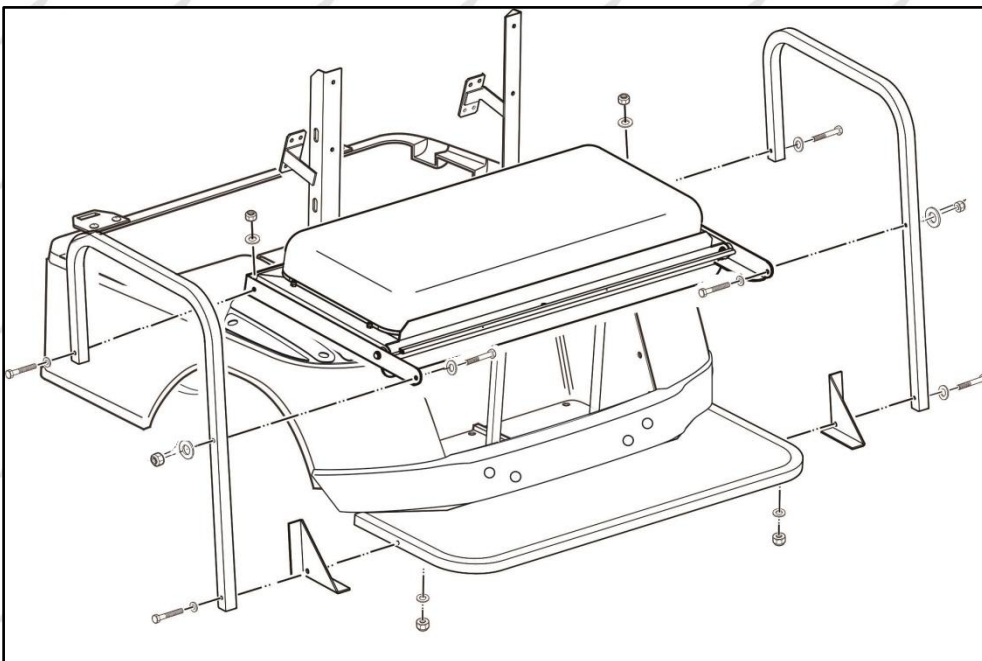

12. Attach arm tube to seat assembly using short bolts from hardware #9.  
Use triangle bracket when attaching to footplate with two long bolts from hardware #9.

## SEAT KIT INSTALLATION INSTRUCTIONS EZGO TXT

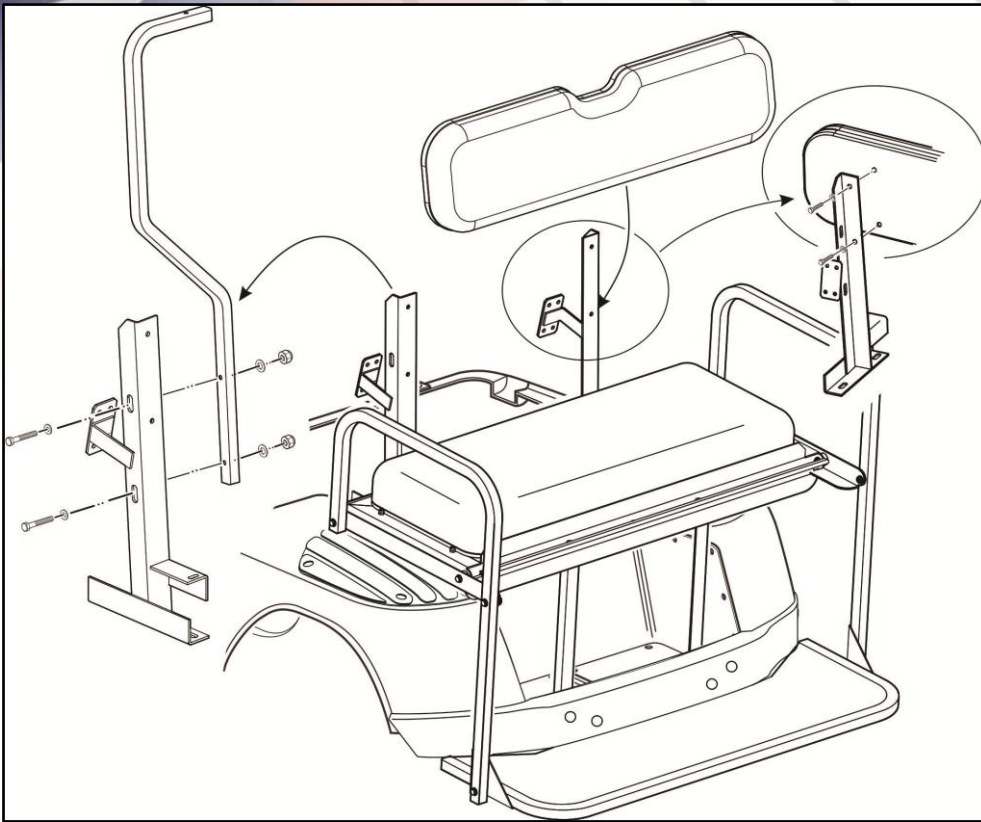

13. Attach factory roof struts to seatback bracket using hardware #12. Attach back cushion using hardware #10.

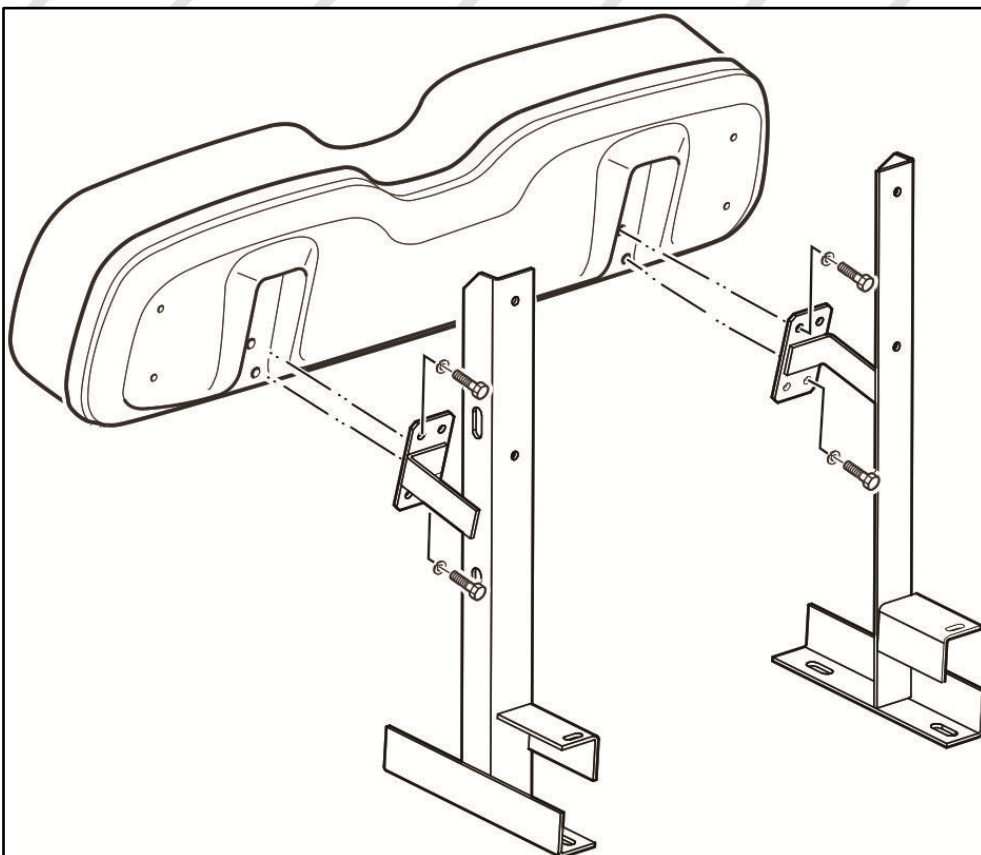

14. Attach front seat back cushion to seatback brackets using factory hardware.

## SEAT KIT INSTALLATION INSTRUCTIONS EZGO TXT

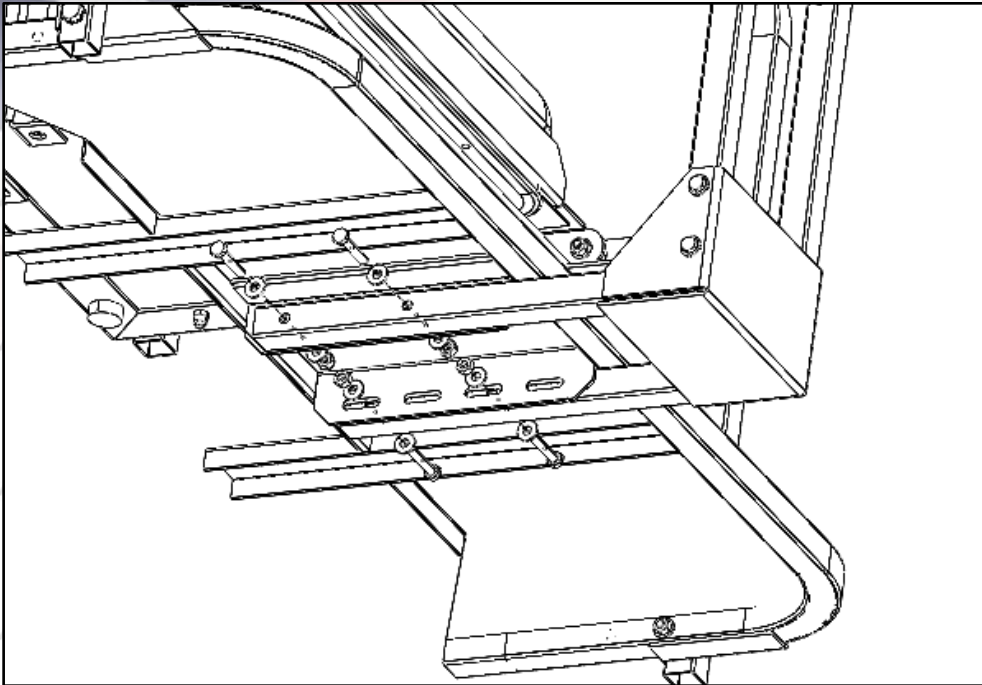

15. Attach grab bar and grab bar mounting bracket to foot plate as shown in picture using hardware #11. Make sure the mounting bracket is installed in correct slotted holes on foot plate.

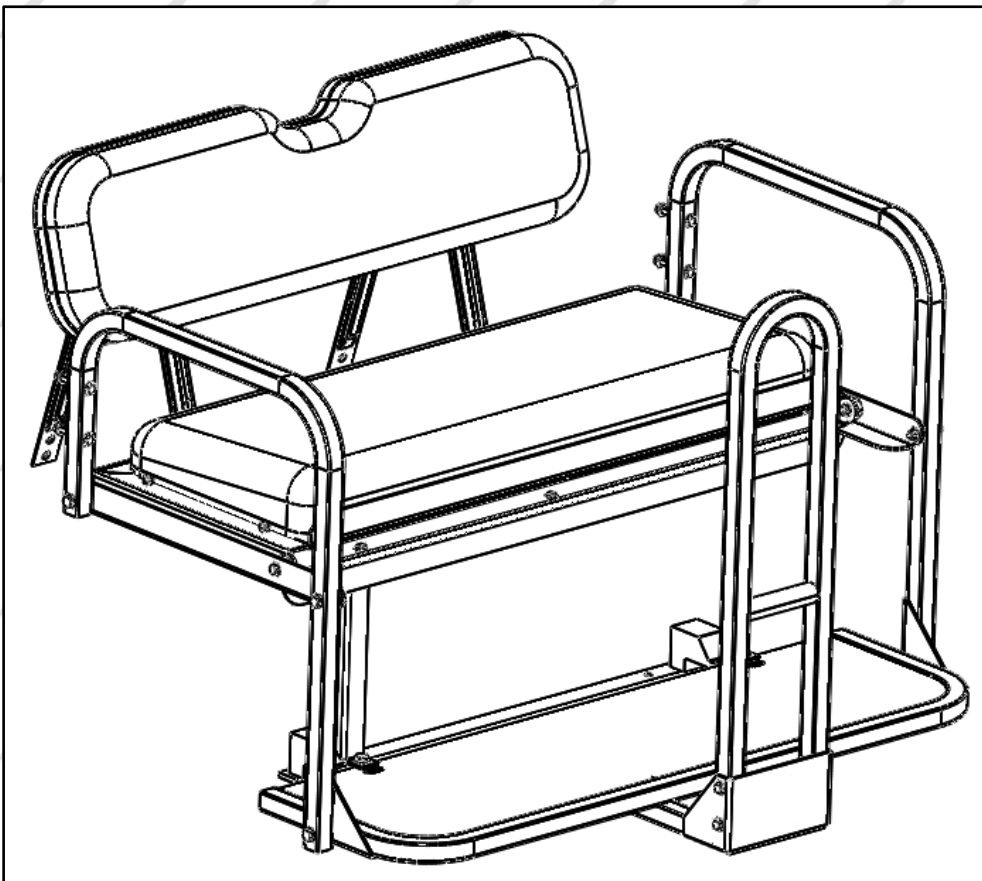

16. This is the final look of Nomad rear flip seat kit for TXT.





## RETURN MERCHANDISE AUTHORIZATION

Dear Valued Customer,

Thank you for choosing Steeleng Golf Cart Accessories for your golf cart needs.

We apologize for the issues you are having with your purchase. We strive to offer the absolute best quality at the absolute best price.

To best serve you, we do need a little information to help process your return and/or exchange faster.

Please complete the following and include this entire form with your return.

\_\_\_\_\_  
Name

\_\_\_\_\_  
Shipped To Address

\_\_\_\_\_  
STATE

\_\_\_\_\_  
ZIP

Purchased with:                      eBay

Direct Phone Order

This is for              EXCHANGE              REFUND

Please describe reason for return:-

\_\_\_\_\_  
\_\_\_\_\_  
\_\_\_\_\_  
\_\_\_\_\_

Our Return Address:

Steeleng Golf Cart Accessories

3309 Laurens Road,

Greenville, SC 29607

Tele: 864-675-1103

\_\_\_\_\_  
For Office Use Only:

Received By: \_\_\_\_\_

Date \_\_\_\_\_

Refund Amount \_\_\_\_\_

Exchange Issued \_\_\_\_\_

**\*\*Steeleng Golf Cart Accessories reserves the right to charge a 15% restocking fee for all returned and/or exchanged items.**